

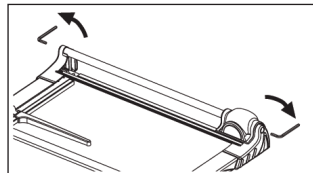

Replacing the Cutting Blade Head

1. Use the Allen wrench provided to remove the screws on each end of the guide rail.
2. Carefully remove the cutter set by lifting the guide rail and sliding off the cutting blade head.
3. Carefully slide the new cutting blade head onto the guide rail. Lower the cutter set back onto the base. Be sure to set the blade on the outside of the cutting shield.
4. Use the Allen wrench to install the screws and tighten into place.

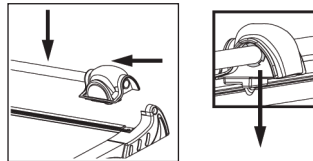
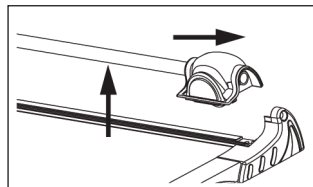
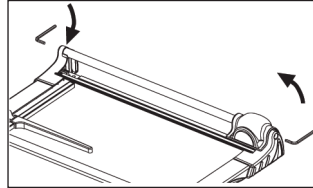

Rotary Trimmers



Care and Maintenance

To avoid damaging the trimmer, never immerse it in water or other liquids.

Do not use abrasive cleaners on the trimmer.

Dust the trimmer with a soft cloth, using extreme caution when cleaning near the blade.

Parts Identification

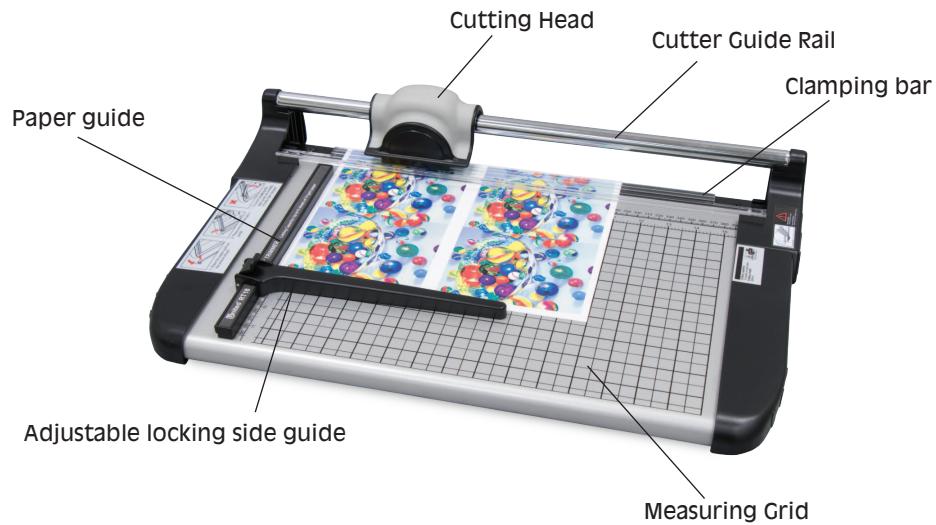

Safety Precautions

Before using the trimmer, please read and follow these instructions, and keep them handy for future reference.

1. Read all instructions before operating.
2. This product is not intended for use by children. Keep product out of reach of children and pets.
3. This trimmer is designed to cut only paper. Do not use it to cut other objects.
4. Keep hands and loose items, i.e. jewelry, clothing, neckties, etc. away from the blade to avoid personal injury and/or damage to the trimmer.
5. Do not attempt to dislodge jammed debris with a pointed object, as personal injury or damage to the trimmer may occur.
6. Always use the trimmer on a flat, level, sturdy surface.
7. Do not hang or wall-mount the trimmer.
8. This product is intended for indoor use only.

To avoid damage to the trimmer:

- Remove paper clips and staples from items before trimming.
- Never lubricate the cutting blade.
- Do not expose the trimmer to water or other liquids.

To avoid possible severe personal injury:

- Never use the trimmer without the blade guard in place.
- Never carry the trimmer by the blade or blade handle.

Operation

1. Install the side guide by opening the latch and sliding it along the paper guide as shown at right.
2. Press and lock the side guide to hold it in place.

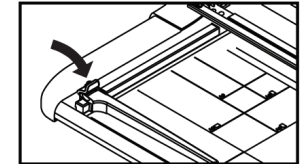
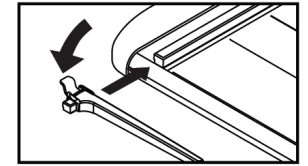

NOTE: To avoid breaking the side guide, do not lift it by the end. Only move it by sliding side to side.

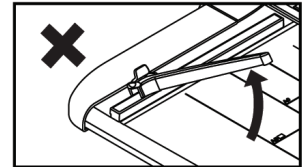

3. Insert paper under the clamping bar.
4. Slide the side guide to the proper position and lock it in place.

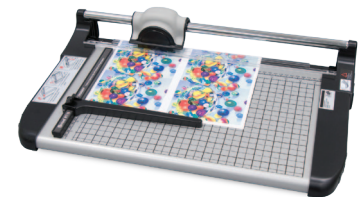

5. Press and slide the rotary blade head forward or backward to cut through the paper. The blade cuts in both directions.

